

Note: <注意>

Mechanical: <机械性能>

- .Contact force: 0.8N±20.2N at 1.15mm working stroke
<接触弹力: 0.8N±20.2N 在1.15mm的工作行程>
- .Full stroke: 1.60mm
<最大行程: 1.60mm>
- .Life test: 50,000 cycles
<寿命: 50000次>

Electrical: <电气性能>

- .Rated current & voltage: DC 24V, 3A Max.
<额定电压, 电流: DC 24V, 3A>
- .Contact resistance: 50 milliohm Max.
<接触阻抗: 50 milliohm Max.>
- .When the current is greater than 1A then need to increase the time delay circuit(3 second)
<当电流大于1A时, 则需要增加延时电路(3秒)>

100% open & short test.

100% 开路/短路测试。
 *Dimension, "CPK" Marked is cpk dimension, they must be checked by QC.
 <标示 "★" 是重点尺寸, 标示 "CPK" 是cpk尺寸, 他们必须被QC检查。>
 First Part Inspections are marked by ball marker "O"
 用球标标示的是首件尺寸 "O"

The product must be checked for use by male and female

- <产品必须做公母对接使用检验>
- .The magnetic adsorption force of male and female is 500g Min.
<公母吸附力为500g最小>

Environment performance: <环境性能>

- .Operating Temp: -30 to +60°C
<工作温度: -30 to +60°C>
- .Salt spray: 24h
<盐雾测试: 24小时>
- .RoHS TSCA compliant product
<符合RoHS, TSCA产品要求>
- .产品单重: 0.0Xg

6	CFE standard packing CFE 标准包装		
5	Lucency, LSR67 透明, 乐赛尔67胶水	LSR-67	0.05mL
4	Pogo pin plating 0.25um Au <弹簧针 电镀金0.25um>	BP14211	1
3	The C3604 is nickel-plated 24 hours <C3604 表面镀镍 盐雾测试24小时>	B142-W2100	1
2	N35 NdFeB Magnet plating Ni-Cu-Ni <N35 钕铁硼磁铁 表面镀镍铜镍>	B142-M8100	1
1	Black HTN UL94 V-0 <黑色 HTN UL94 V-0>	O1000-H03	1
序号 <NO.>	规格 <Specification>	料号 <P/N>	数量 <Qty>
2Pin black magnetic suction connector 2Pin 黑色 磁吸式连接器			

To ensure the best usage, please operate it based on the working height.
 为确保最佳使用, 请根据工作高度进行操作。
 Based on the engineering drawings, shall not exceed the maximum allowed compression
 根据工程图纸, 不应超过允许的最大压缩量。

Approve Signature

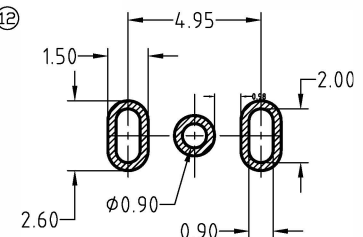
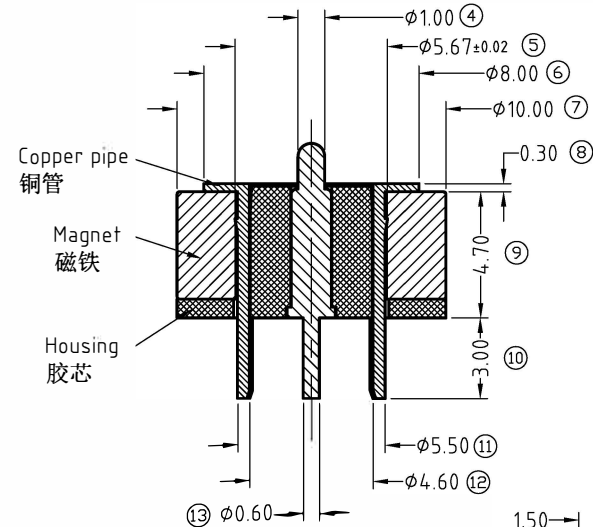
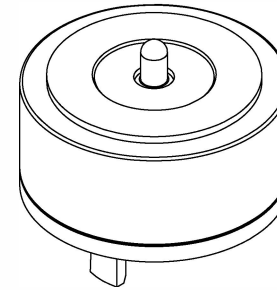
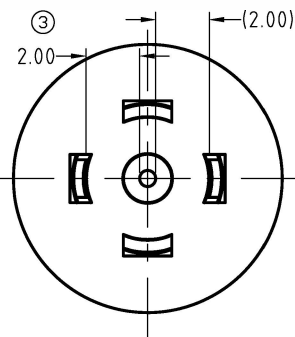
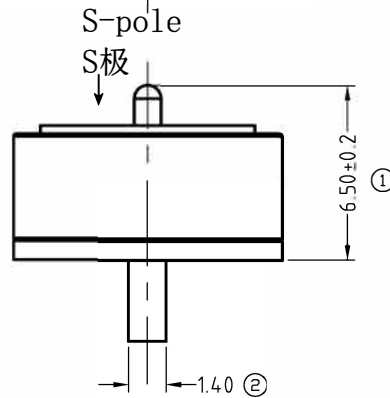
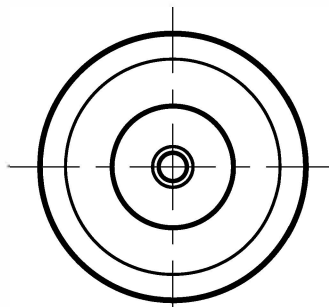

Recommended pcb layout
 layout tolerance: ±0.05mm
 PCB推荐设计, 设计公差±0.05mm (R)

SCALE	NA	UNIT: mm	THIS DOCUMENT IS THE SOLE PROPERTY OF CFE CORPORATION CO., LTD., AND SHOULD NOT BE USED IN WHOLE OR IN PART WITHOUT PRIOR WRITTEN PERMISSION.	
ANGEL	±2°	A4		
0~6	±0.10		SHEET: 1 of 1	
>6~30	±0.20	DRAW	Miya	PART NO. MMA000204-01A1A0
>30	±0.30	CHECK	Michael	FILE NAME BP142XX
GENERAL TOLERANCE UNLESS OTHERWISE NOTED		APPRO	Army	TITLE. Magnetic connector/磁吸连接器

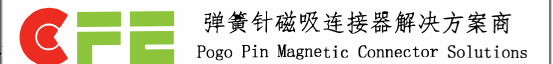

AO	2014. 11. 18	New Release新发行
REV	DATE日期	DESCRIPTION描述