

1

2

3

4

Note:<注意>

Mechanical:<机械性能>

.Contact force: 40g±20g at 0.6mm working stroke

<接触弹力: 40g±20g在0.6mm的工作行程>

.Life test: 20,000 cycles

<寿命: 20000次>

Electrical:<电气性能>

.Rated current & voltage: DC 12V, 1A

<额定电压, 电流: DC 12V, 1A>

.Contact resistance: 50 milliohm Max.

<接触阻抗: 50 milliohm Max.>

100% open & short test.

<100%导通,短路测试>

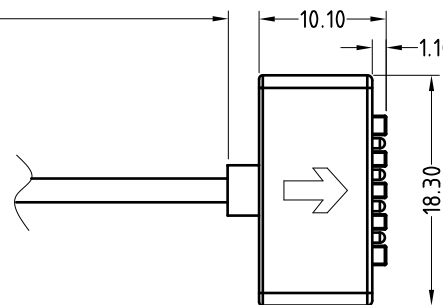
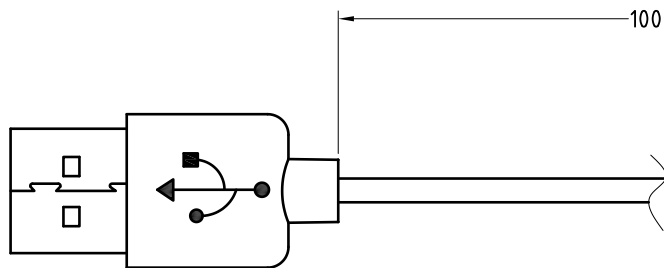
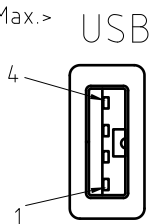

Pogo pin conn

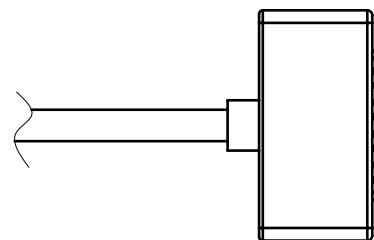
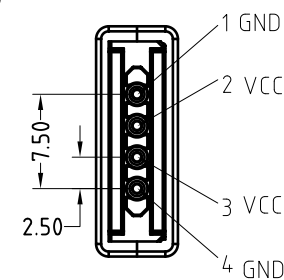

PIN OUTS

USB		Pogo pin
4	GND	1
1	VCC	2
1	VCC	3
4	GND	4

SCALE	10:1	UNIT:mm	THIS DOCUMENT IS THE SOLE PROPERTY OF CFE CORPORATION CO.,LTD., AND SHOULD NOT BE USED IN WHOLE OR IN PART WITHOUT PRIOR WRITTEN PERMISSION.	SHEET: 1 of 1		东莞市川富电子有限公司	
ANGEL	±1°	A4				CFE CORPORATION CO.,LTD.	
0~6	±0.05				PART NO.	CM-BP27011-04250H0A	
6~30	±0.10	DRAW			FILE NAME	BP270XX	
30~150	±0.15	CHECK	TITLE	Pogo pin connector			
GENERAL TOLERANCE UNLESS OTHERWISE NOTED			APPRO				

ECN(DCN) NO.	A0	2015.17	NEW
REV	DATE	DESCRIPTION	