

Note:<注意>  
 Mechanical:<机械性能>  
 .Contact force: 40g±20g at 0.6mm working stroke  
 <接触弹力: 40g±20g在0.6mm的工作行程>  
 .Life test: 50,000 cycles  
 <寿命: 50000次>  
 Electrical:<电气性能>  
 .Rated current & voltage: DC 12V, 2A  
 <额定电压, 电流: DC 12V, 2A>  
 .Contact resistance: 50 milliohm Max.  
 <接触阻抗: 50 milliohm 最大>  
 100% open & short test.  
 <100%导通,短路测试>  
 .Magnetic attraction force:900g±20g.  
 磁吸力: 900g±20g

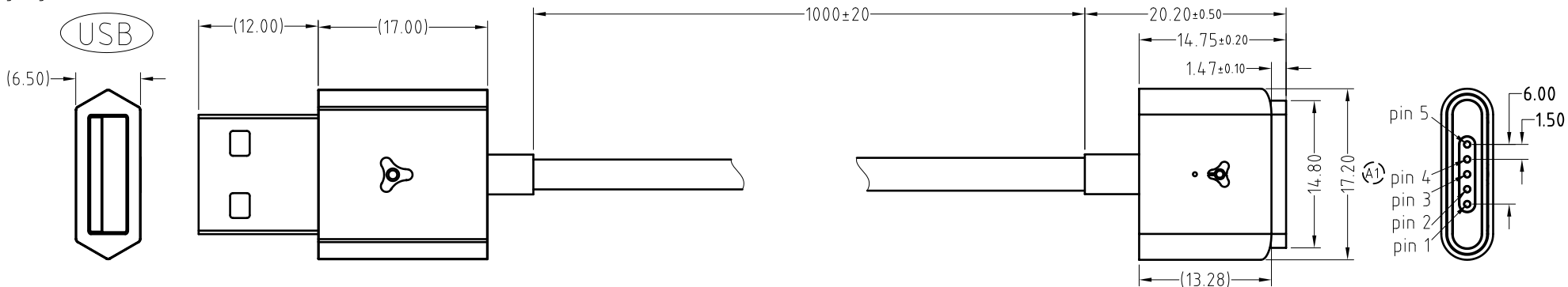

Approve Sign

Pogo pin conn



|                   |
|-------------------|
| USB→Pogo pin conn |
| 1_Vcc_1           |
| 2_D-_2            |
| 3_D+_3            |
| 4_GND_4           |

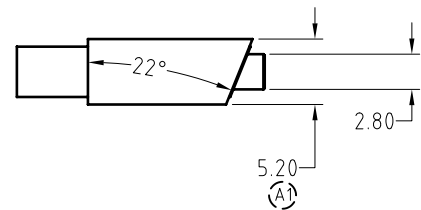

| ECN(DCN) NO. | REV | DATE       | DESCRIPTION   |
|--------------|-----|------------|---------------|
|              | T3  | 2015.08.31 | Pin针统一变为40g   |
|              | T2  | 2015.08.13 | 线材要求变更        |
|              | A1  | 2015.07.29 | 更改线径大小、接头外形尺寸 |
|              | A0  | 2015.06.30 | NEW           |

|  |       |         |  |               |          |                          |
|--|-------|---------|--|---------------|----------|--------------------------|
| SCALE                                    | 10:1  | UNIT:mm | THIS DOCUMENT IS THE SOLE PROPERTY OF CFE CORPORATION CO.,LTD., AND SHOULD NOT BE USED IN WHOLE OR IN PART WITHOUT PRIOR WRITTEN PERMISSION. | SHEET: 1 of 1 | PART NO. | CM-BP43011-05150H0C      |
| ANGEL                                    | ±1°   | A4      |  |               |          |                          |
| 0~6                                      | ±0.10 |         |  |               | TITLE.   | Magnetic Cable Connector |
| 6~30                                     | ±0.15 | DRAW    |  |               |          |                          |
| 30~150                                   | ±0.20 | CHECK   |  |               |          |                          |
| GENERAL TOLERANCE UNLESS OTHERWISE NOTED |       | APPRO   |  |               |          |                          |

