

Note:<注意>

Electrical:<电气性能>

Rated current & voltage: DC 12V, 2A

<额定电压, 电流: DC 12V, 2A>

Contact resistance: 50 milliohm Max.

<接触阻抗: 50 milliohm 最大.>

100% open & short test.

<100%导通,短路测试>



Approve Sign

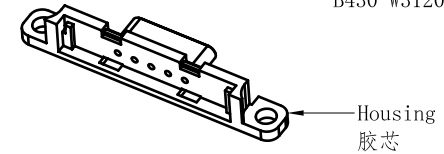
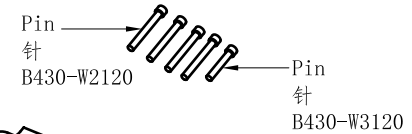
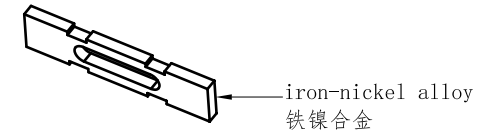
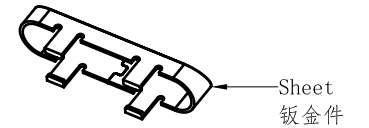
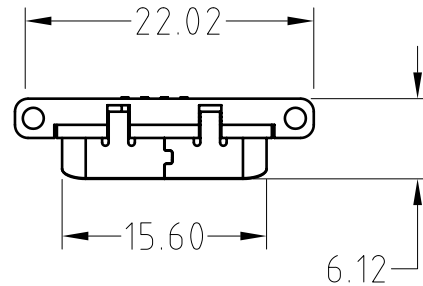
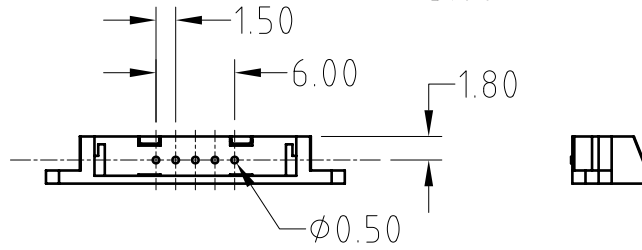
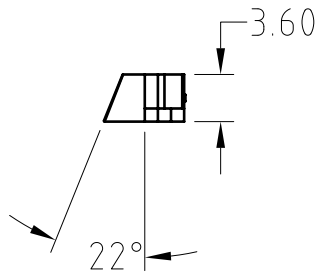
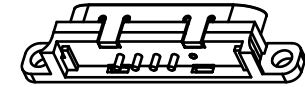
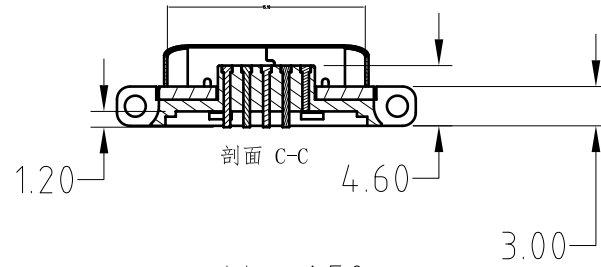

SCALE	1:1	UNIT:mm	THIS DOCUMENT IS THE SOLE PROPERTY OF CFE CORPORATION CO.,LTD., AND SHOULD NOT BE USED IN WHOLE OR IN PART WITHOUT PRIOR WRITTEN PERMISSION.	CFE 东莞市川富电子有限公司 CFE CORPORATION CO.,LTD.	
ANGEL	±1°	A4	SHEET: 1 of 1		
0~6	±0.10			PART NO.	M-BP43021-05150H0C
6~30	±0.15	DRAW		FILE NAME	BP430XX
30~150	±0.20	CHECK		TITLE.	Magnetic Cable Connector
GENERAL TOLERANCE UNLESS OTHERWISE NOTED		APPRO			

ECN(DCN) NO.	REV	DATE	DESCRIPTION
	A0	2015.09.10	NEW