

Note (注):

Mechanical (机械性能):

.Contact force: 70g±20g at 1.0mm working stroke

(接触弹力: 70g±20g在1.0的工作行程)

.Life test: 20,000 cycles

(寿命测试: 20000次)

Electrical (电气性能):

.Rated current & voltage: DC 12V, 1A

(额定电压, 额定电流: DC12V, 1A)

.Contact resistance: 50 milliohm Max.

(接触阻抗: 50mΩ)

100% open & short test.

100%短开路测试

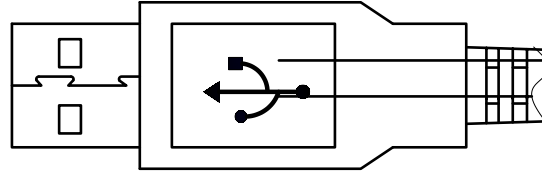
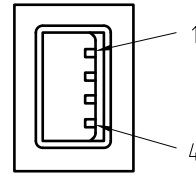

300±20

Pogo pin conn

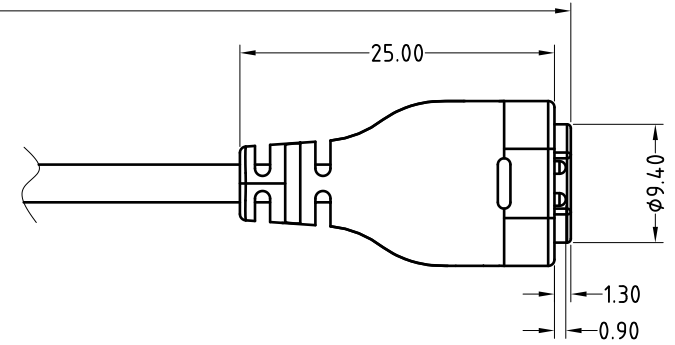

F=100g (F=100g的力度)

Bending Test: (摇摆测试)  
 Swing strength 100g, (摇摆力度 100g), swinging arc (摆弧 120°)  
 frequency :30cycles/min Swing times>1000cycles; Wire rod is not broken, damaged (频率30次/分钟, 摇摆次数≥1000次 线材不得断裂, 破损)

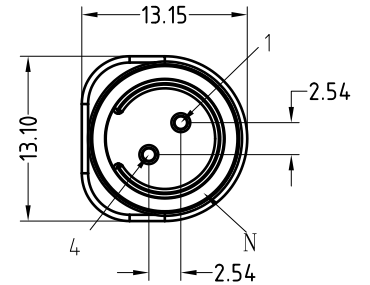

PIN OUTS

USB	Color	Pogo pin
1	Red	1
4	Black	4

SCALE	10:1	UNIT:mm	THIS DOCUMENT IS THE SOLE PROPERTY OF CFE CORPORATION CO.,LTD., AND SHOULD NOT BE USED IN WHOLE OR IN PART WITHOUT PRIOR WRITTEN PERMISSION.
ANGEL	±1°	A4	
0~6	±0.05		
6~30	±0.10	DRAW	
30~150	±0.15	CHECK	
GENERAL TOLERANCE UNLESS OTHERWISE NOTED			APPRO

东莞市川富电子有限公司 CFE CORPORATION CO.,LTD.	
PART NO.	CM-BP21611-02254H0F
FILE NAME	BP216XX
TITLE.	Pogo pin connector

ECN(DCN) NO.	REV	DATE	DESCRIPTION
	A0	2014.10.23	NEW