

Note:<注意>
 Electrical:<电气性能>
 .Rated current & voltage: DC 12V, 1A .
 <额定电压, 电流: DC 12V, 1A>
 .When the current is greater than 1A then need to
 increase the time delay circuit(3 second)
 100% open & short test.
 <100%导通, 短路测试>

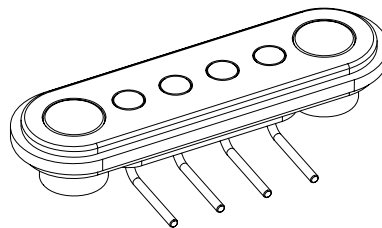
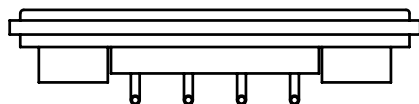
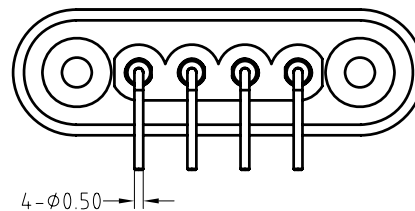
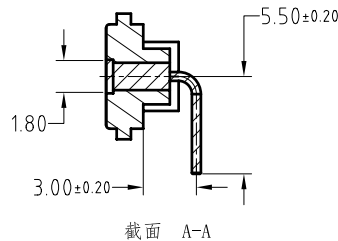
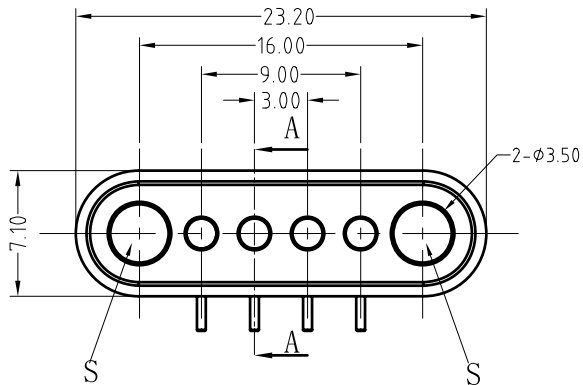
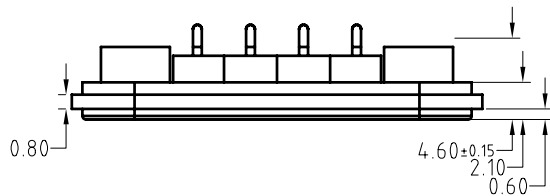

Approve Sign

3	Pin plating 0.125um Au <Pin针 电镀金0.125um>	B1104-W1005	4
2	N52 NdFeB Magnet plating Ni-Cu-Ni <N52 钕铁硼磁铁 表面镀镍铜镍+铜套铆接>	B1104-E2100	2
1	Black HTN UL94 V-0 <黑色 HTN UL94 V-0>	B1104-H2000	1
序号 <NO. >	规格 <Specification>	料号 <P/N>	数量 <Qty>

SCALE	10:1	UNIT:mm	THIS DOCUMENT IS THE SOLE PROPERTY OF CFE CORPORATION CO.,LTD., AND SHOULD NOT BE USED IN WHOLE OR IN PART WITHOUT PRIOR WRITTEN PERMISSION.
ANGEL	±2°	A4	
0~6	±0.10		SHEET: 1 of 1
6~30	±0.20	DRAW	
30~150	±0.30	CHECK	
GENERAL TOLERANCE UNLESS OTHERWISE NOTED		APPRO	

CFE 东莞市川富电子有限公司
 CFE CORPORATION CO.,LTD.

_____	D1	2017.06.28	尾巴加长2.5mm磁铁外径改为3.5mm
_____	D0	2017.06.27	NEW
ECN(DCN) NO.	REV	DATE	DESCRIPTION

PART NO.	M-BP110421-04300H0E
FILE NAME	BP1104XX
TITLE.	Magnetic Connector/磁吸连接器