

1

2

3

4

Note:<注意>

Mechanical:<机械性能>

.Contact force: 70g±20g at 1.0mm working stroke

<接触弹力: 70g±20g在1.0mm的工作行程>

.Life test: 20,000 cycles

<寿命: 20000次>

Electrical:

Electrical:<电气性能>

.Rated current & voltage: DC 5V, 1A

<额定电压, 电流: DC 5V, 1A>

.Contact resistance: 50 milliohm Max.

<接触阻抗: 50 milliohm Max.>

100% open & short test.

<100%导通,短路测试>



USB

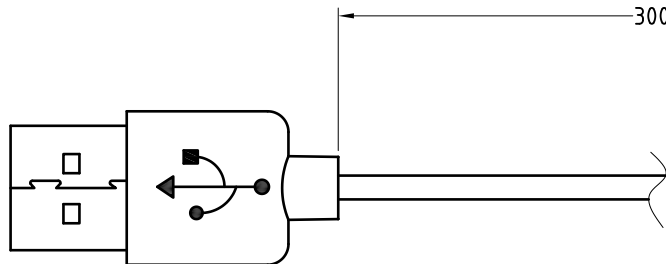
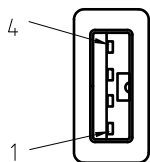

300±20

(23.50)

Pogo pin conn

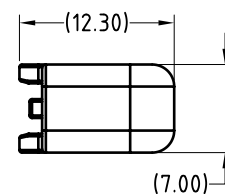
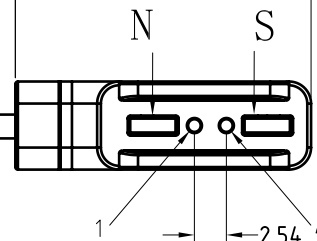

Docking magnet force 150g.
(对接端吸附力为150g)

USB→Pogo pin conn
1_Vcc_1
4_GND_4

SCALE	10:1	UNIT:mm	THIS DOCUMENT IS THE SOLE PROPERTY OF CFE CORPORATION CO.,LTD., AND SHOULD NOT BE USED IN WHOLE OR IN PART WITHOUT PRIOR WRITTEN PERMISSION.	东莞市川富电子有限公司 CFE CORPORATION CO.,LTD.	
ANGEL	±1°	A4			
0~6	±0.05				SHEET: 1 of 1
6~30	±0.10	DRAW			PART NO. CM-BP26511-02254H0A
30~150	±0.15	CHECK	FILE NAME BP265XX	TITLE. Pogo pin connector	
GENERAL TOLERANCE UNLESS OTHERWISE NOTED		APPRO			

ECN(DCN) NO.	REV	DATE	DESCRIPTION
	D1	2015.06.12	修改PIN针
	A0	2015.03.09	NEW