

Note:<注意>

Mechanical:<机械性能>

.Contact force: 70g±20g at 1.0mm working stroke

<接触弹力: 70g±20g在1.0mm的工作行程>

.Full stroke:1.40mm

<最大行程: 1.40mm>

.Life test: 20,000 cycles

<寿命: 20000次>

Electrical:<电气性能>

.Rated current & voltage: DC 12V, 2A

<额定电压, 电流: DC 12V, 2A>

.Contact resistance: 50 milliohm Max.

<接触阻抗: 50 milliohm Max.>

100% open & short test

<100%导通,短路测试>

To ensure the best usage, please operate it based on the working height.(为保最佳应用, 请基于工作高度使用)

Based on the engineering drawings, shall not exceed the maximum allowed compression. (基于工程图纸, 不要超出最大允许压缩行程)



Approve Sign

CONN

A

B

C

D

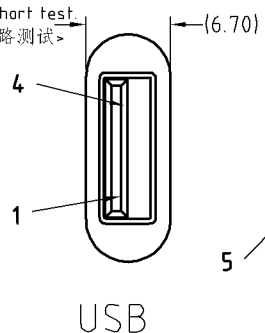

USB

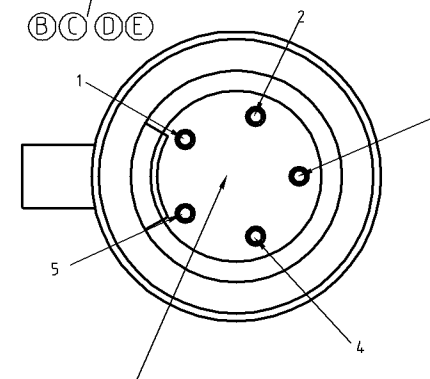
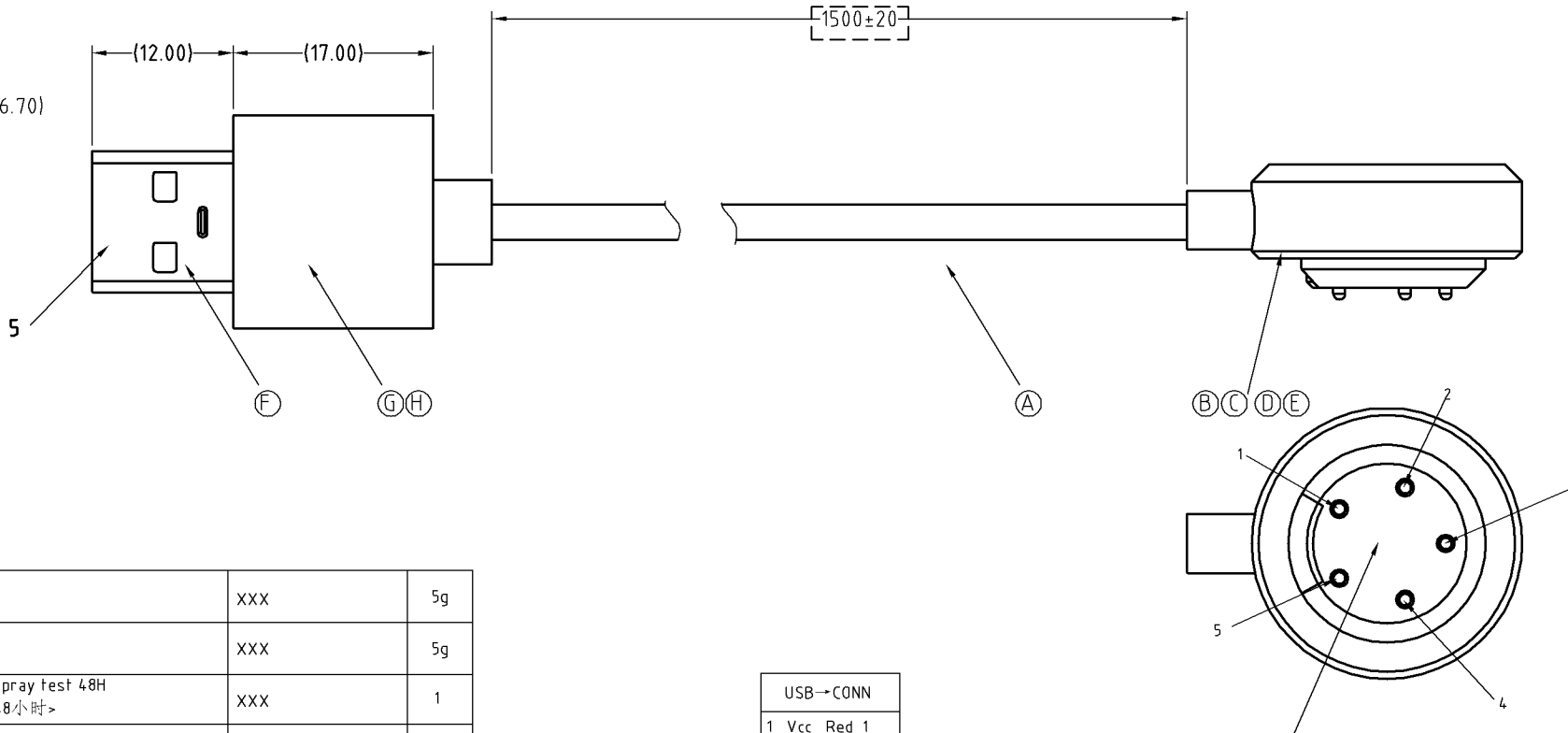

S Docking magnet force xxx g.  
(S极 对接端吸附力为XXXg)

H	Black/White PVC 45P <黑/白色 PVC 45P>	XXX	5g
G	Lucency PE <透明 PE>	XXX	5g
F	USB/AM 0.025um Au White salt spray test 48H <USB/AM 0.025um金 白色盐雾48小时>	XXX	1
E	Pogo pin plating 0.25um Au <弹簧针 电镀金0.25um>	MP310-1122	5
D	N50 NdFeB Magnet plating Ni <N50 钕铁硼磁铁表面镀镍>	B522-M1100	1
C	Black ABS UL94 V-0 <黑色ABS UL94 V-0>	B522-H4004	1
B	Black ABS UL94 V-0 <黑色ABS UL94 V-0>	B522-H3001	1
A	OD4.0 5C 7×0.12 Black Jacket PVC 55P <OD4.0 5芯 7×0.12 黑色外被PVC 55P>	XXX	1540mm
序号 (NO.)	规格 (Specification)	料号 (P/N)	数量 (Qty)

USB→CONN
1_Vcc_Red_1
2_D-_White_2
3_D+_Green_3
4_GND_Black_4
5_地线_Blue_5

SCALE	10:1	UNIT:mm	THIS DOCUMENT IS THE SOLE PROPERTY OF CFE CORPORATION CO.,LTD., AND SHOULD NOT BE USED IN WHOLE OR IN PART WITHOUT PRIOR WRITTEN PERMISSION.	<b>CFE</b> 东莞市川富电子有限公司 CFE CORPORATION CO.,LTD.	
ANGEL	±2°	A4			
0-6	±0.10		SHEET: 1 of 1	PART NO.	CM-BP52221-05254H0C
6-30	±0.20	DRAW		FILE NAME	BP522XX
30-150	±0.30	CHECK		TITLE	Magnetic Cable Connector
GENERAL TOLERANCE UNLESS OTHERWISE NOTED		APPRO			

ECN(DCN) NO.	REV	DATE	DESCRIPTION
	D0	2015.08.20	NEW